

15 CHECK

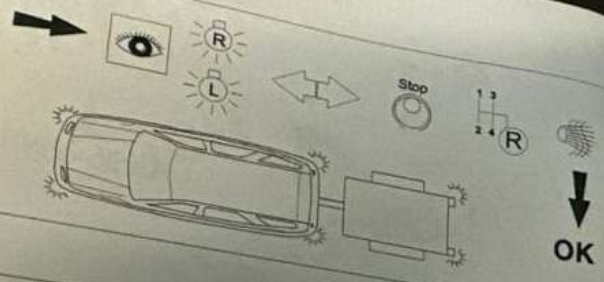

16

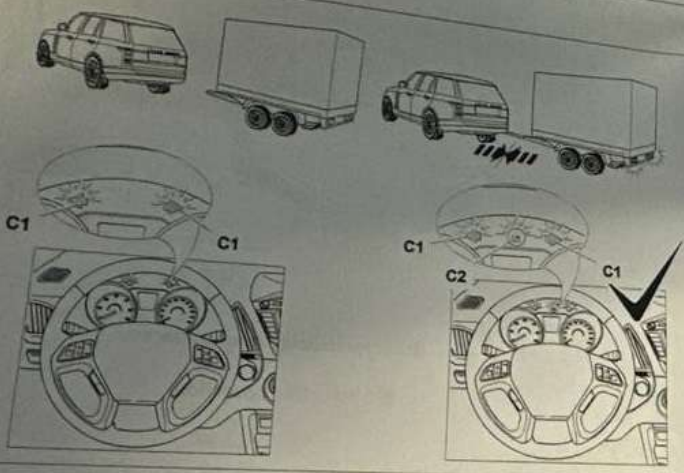

17

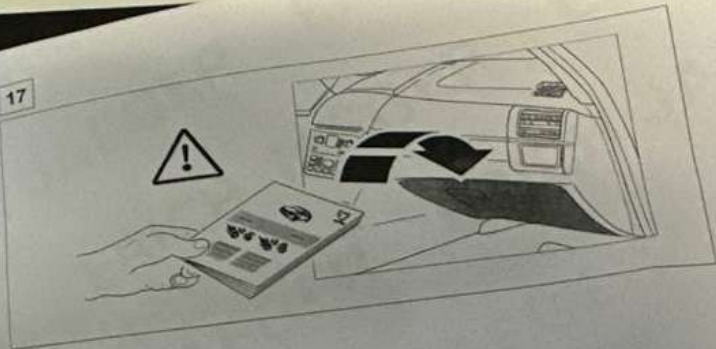

11

7 + 13 PIN

1	bk/wh	◇	8	bu/rd	⚡
2	gy	⚡	9	rd	⚡
3	wh/bn	⚡	10	ye	⚡
4	bk/gn	⚡	11	bn/gn	⚡
5	gy/rd	⚡	12	no	-/-
6	bk/rd	⚡	13	bn	⚡
7	gy/bk	⚡			

12

12	bk	wh	gy	gn	rd	bu	ye	bn	pu	or	no
D	schwarz	weiß	grau	grün	rot	blau	gelb	braun	violett	orange	rot
GB	black	white	grey	green	red	blue	yellow	brown	purple	orange	red
F	noir	blanc	gris	vert	rouge	bleu	jaune	brun	violet	orange	rouge
NL	zwart	wit	grijs	groen	rood	blauw	geel	bruin	violet	oranje	rood
DK	sort	hvid	grå	grøn	rød	blå	gul	brun	violet	orange	rød
N	svart	hvit	grå	grøn	rød	blå	gul	brun	violet	orange	rød
S	svart	vitt	grå	grön	röd	blå	gul	brun	violet	orange	röd
FIN	musta	valkoinen	harmaa	vihreä	punainen	sininen	keltainen	ruskea	violetti	oranssi	punainen
I	nero	bianco	grigio	verde	rosso	blu	giallo	marone	violetto	arancione	rosso
E	negro	blanco	gris	verde	rojo	azul	amarillo	marón	violeta	naranja	rojo
P	negro	blanco	gris	verde	rojo	azul	amarillo	marón	violeta	naranja	rojo
GR	μαύρο	λευκό	γκρί	πράσινο	κόκκινο	μπλε	κίτρινο	καφέ	βιολετί	πορτοκαλί	κόκκινο
PL	czarny	biały	szary	zielony	czarny	niebieski	żółty	brązowy	fioletowy	pomarańczowy	czarny
CZ	černý	bílý	šedý	zelený	červený	modrý	žlutý	hnědý	fialový	oranžový	černý
TR	siyah	beyaz	gri	yeşil	kırmızı	mavi	sarı	kahverengi	mor	portakal rengi	siyah
H	schwarz	weiß	grau	grün	rot	blau	gelb	braun	violett	orange	rot
HR	crno	bijelo	sivo	zeleno	crveno	plavo	zuto	smeđe	ljubičasto	narandžasto	crno
BUL	чорно	бяло	сиво	зелено	червено	плато	жълто	кафяво	виолетно	оранжево	черно
RO	negru	alb	gri	verde	roșu	albastru	galben	maro	violet	portocaliu	negru
RU	чёрный	белый	серый	зелёный	красный	синий	жёлтый	коричневый	фиолетовый	оранжевый	чёрный
LT	juoda	baltas	pilka	zalia	raudona	malyne	geltona	ruda	purpurine	oranžine	juoda
LV	melns	balts	pelēka	zila	sarkana	zila	dzeltena	brūna	purpur-sarkana	oranža	melns
EST	must	valge	hall	roheline	punane	sinine	kollane	pruun	purpur-punane	oranž	valge
SLV	črna	bela	siva	zelená	rdeča	modra	rumena	smeđ	vijoličast	oranžen	črna
SR	černý	bílý	šedý	zelený	červený	modrý	žlutý	hnědý	fialový	pomaran- čový	černý

13

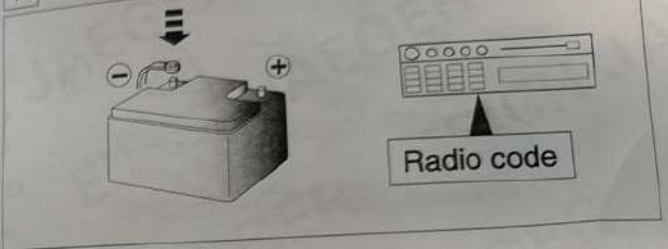

14



Anhängerbetrieb konfigurieren

Set up trailer operation

7

11

737155

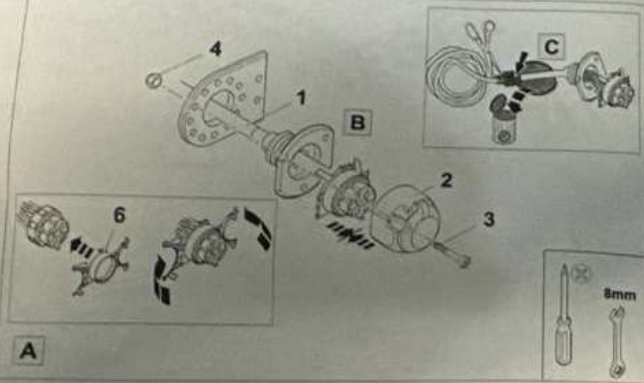

A

8

11

737155

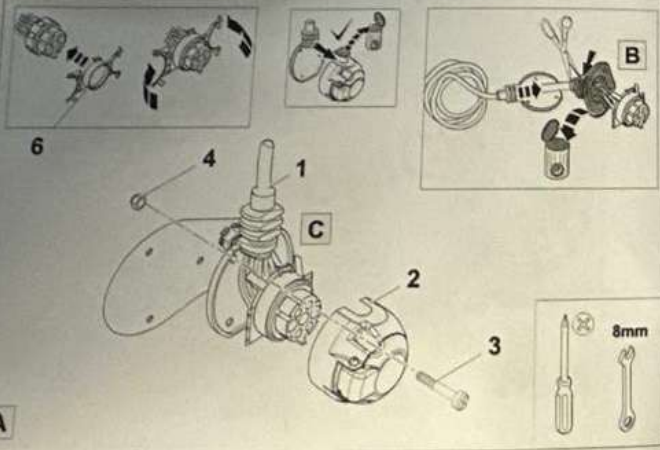

A

9

11

748555

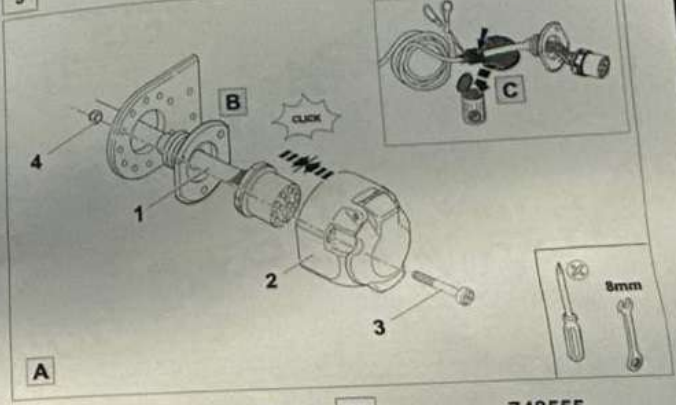

A

10

11

748555

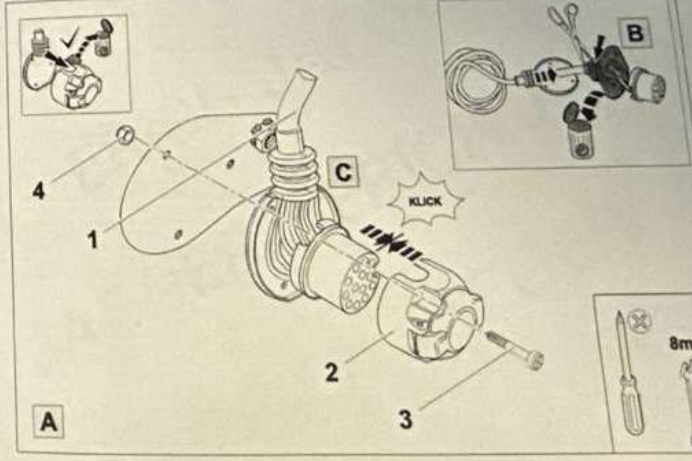

A

3

737155

748555

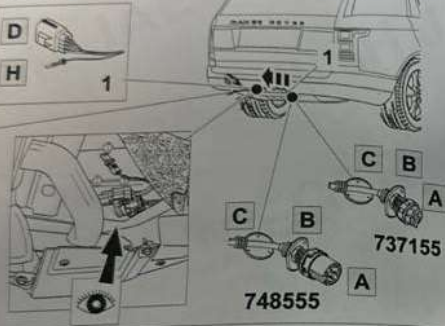

4

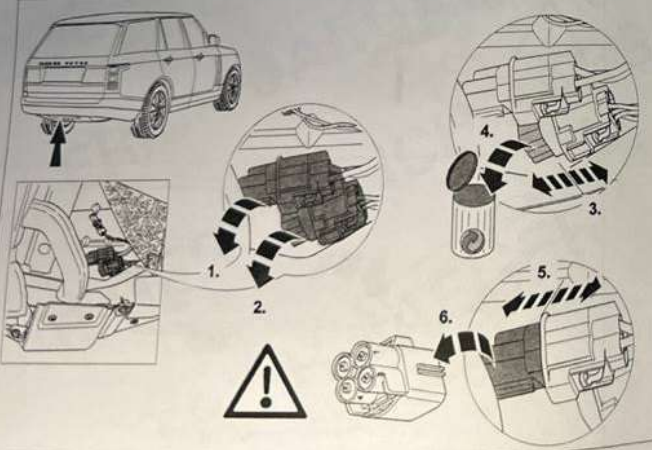

12

748555

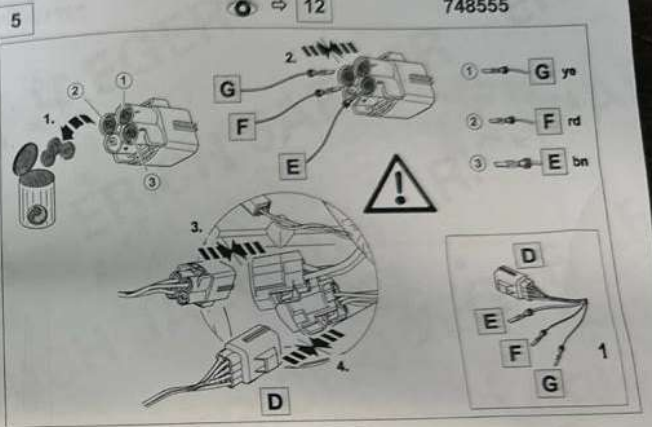

6

12

737155

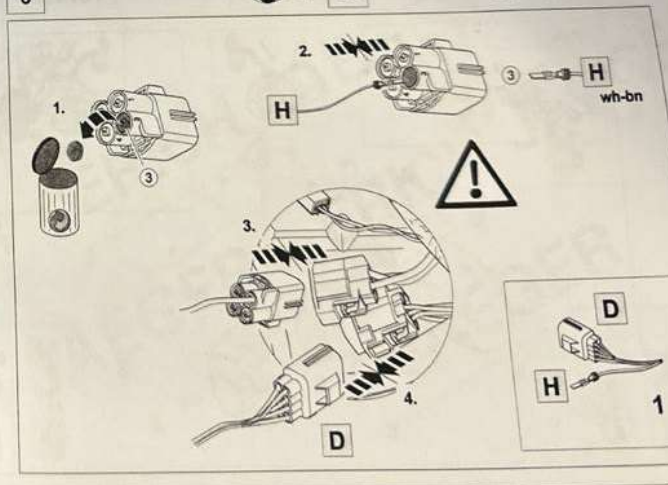

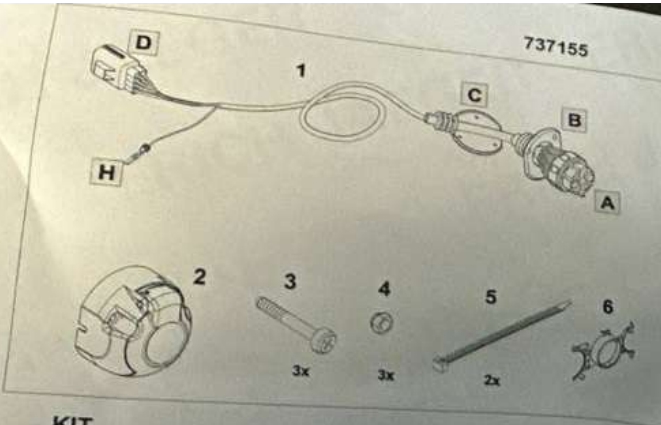

KIT

748555

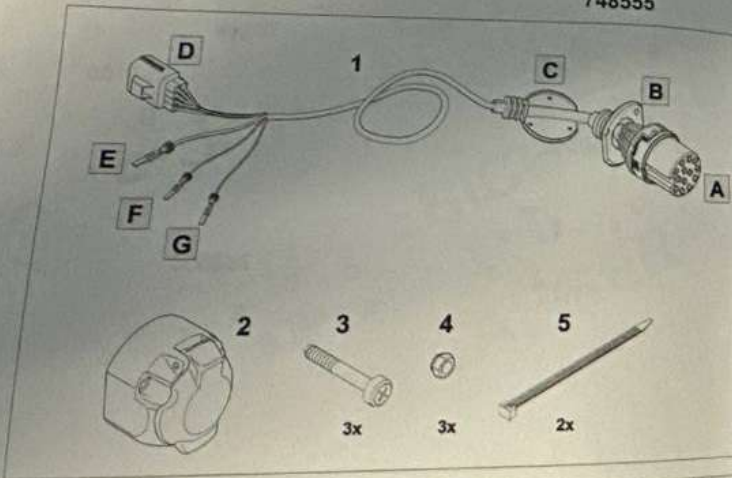

TOOLS

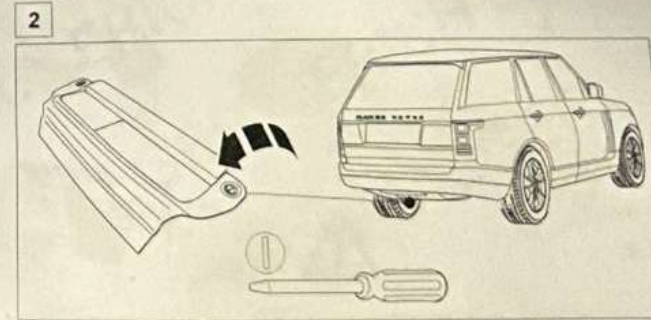
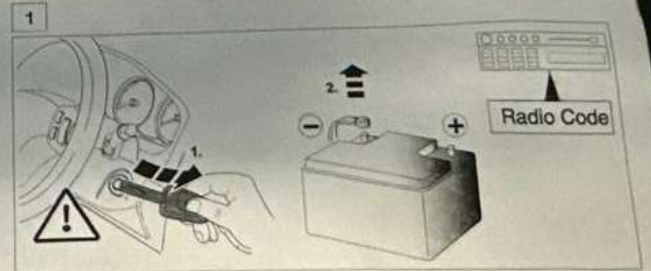
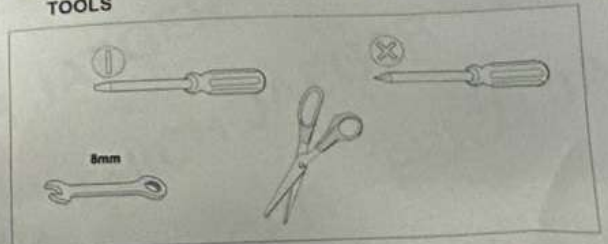

ogramuoti daugiau funkcij
porto priemonės parkavimo
ma (traukti / diagnostines

ir derinimui.

a eksploatacijai ar piekabi
stoai „Automobilja
raksti saistiba ar

tegemise kohta.

meerida vastavalt
seadmetega
sineda kirjeid

a vozila:

ana v skladu z navodili
ne "delovanje
za diagnostiko, v zvezi

avenia

esom, podfa
ariantu vybavenia
otokole, v spojeni

